

	Item	Value	Remark
Input	Nominal voltage	220–240V	
	Nominal frequency	50–60Hz	
	AC voltage range		
	G5R7W150/350/500/700LRP	198–264V	
	G5R7W300LRP	198–277V	
	DC voltage range (start)	NA	
	DC voltage range (operation)	NA	
	Maximum voltage	280Vac	2 h maximum.unit might not operate in this abnormal condition
	Nominal current	85mA	
	Total Harmonic Distortion (THD)	NA	Full load @230VAC
	Power factor	0.5C	Full load @230VAC
	Efficiency		Full load @230VAC
	G5R7W150/350/500LRP	80% (Typ.)	Full load @230VAC
	G5R7W300/700LRP	78% (Typ.)	Full load @230VAC
	No-load power	NA	
Stand-by power	NA		
Protection class	NA		
Inrush current	30A / 70us		
Earth leakage current	NA		
Output	Nominal voltage range		
	G5R7W150LRP	32-42Vdc	
	G5R7W300LRP	13-22Vdc	
	G5R7W350LRP	13-22Vdc	
	G5R7W500LRP	6-13Vdc	
	G5R7W700LRP	5.5-9Vdc	
	Maximum voltage		
	G5R7W150LRP	55Vdc	
	G5R7W300LRP	35Vdc	
	G5R7W350LRP	35Vdc	
G5R7W500LRP	18Vdc		
G5R7W700LRP	25Vdc		

	Item	Value	Remark	
Output	Nominal current range			
	G5R7W150LRP	150mA		
	G5R7W300LRP	300mA		
	G5R7W350LRP	350mA		
	G5R7W500LRP	500mA		
	G5R7W700LRP	700mA		
Output	Current accuracy	± 5%		
	Typical output LF current ripple	± 5%	Low Frequency<120Hz	
	Nominal power range			
	G5R7W150LRP	4.8-6.3W		
	G5R7W300LRP	3.9-6.6W		
	G5R7W350LRP	4.6-7.7W		
	G5R7W500LRP	3-6.5W		
	G5R7W700LRP	3.9-6.3W		
	Maximum power	7.7W		
	Dimming	Dimming control	NA	
Dimming technique		NA		
PWM frequency		NA		
Dimming range		NA		
Lowest dimming current		NA		
Galvanic isolation		NA		
Environment		Ambient temperature range $t_a$	-20°C...+50°C	
	Maximum case temperature $t_c$	75°C		
	Max. case temp. in fault condition	110°C	When operating under fault conditions, the temperature of the enclosure at any location should not exceed 110 °C	
	Storage temperature range	-25°C...+85°C		
	Relative humidity	10%...95%		
	Surge transient protection	1 kV	L/N	
	Environmental rating	Indoor		
	IP rating	IP20		
	Mains switching cycles	> 100,000		
	Expected lifetime	> 80,000 h, $t_c$ 65 °C @ $t_a$ 40 °C	0.1 % / 1,000 h failure rate	
		> 50,000 h, $t_c$ 75 °C @ $t_a$ 50 °C	0.2 % / 1,000 h failure rate	
	Packing	Gross weight/box	11.4 Kg	
		Net weight/box	10.4 Kg	
Pcs/box		90 PCS		
Dimension/box		240(L)*190(W)*185(H)mm		
<b>Protections</b>				
Short- & open circuit proof, Auto. overheat regulation or cut off, Overload protection				
<b>Application</b>				
Outdoor use , potted				
<b>Conformity &amp; Standards</b>				
Safety standard:	EN 61347-1, EN 61347-2-13, EN 62493			
Performance:	EN 62384			
EMC standard:	EN 55015, EN 61000-3-2, EN 61000-3-3, EN 61547			

### Cable information

PRI Connection	L	N
Color	Blue	Brown
Wire type	1332	1332
Wire diameter	AWG18	AWG18
Wire length	141mm	140mm
Stripping	6mm	6mm

SEC Connection	+	-
Color	Red	Black
Wire type	1332	1332
Wire diameter	AWG22	AWG22
Wire length	142mm	143mm
Stripping	10mm	10mm

\*Subject to change without notice, HEP guarantees all products perform functionally well\*

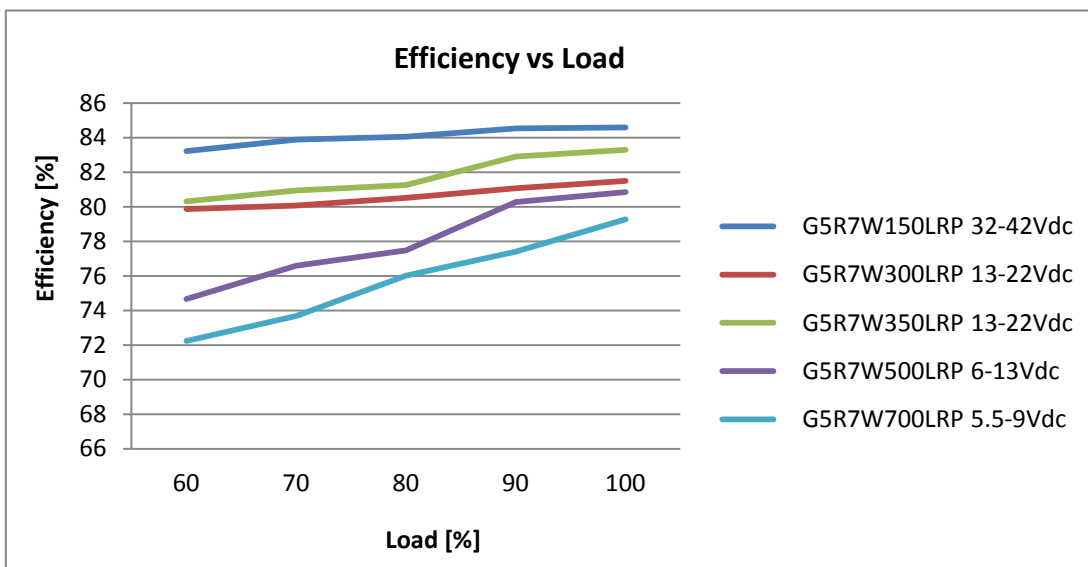

**Physical  
Parameter**

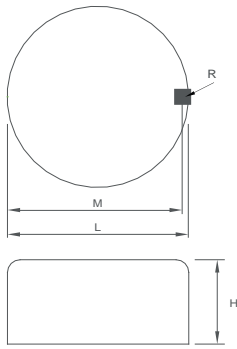

L : 43 mm    H : 20 mm  
M : 41.5 mm    R : 1.6 mm  
Tolerance : +/-1 mm , R : +/-0.5 mm

Housing Material : Polycarbonate / Potting  
Soldering : Lead-Free, Comply With RoHS  
Label : Surface Print

**Wiring Diagram**

